



C-THRU® SEPARATOR

Clearly the next generation of oil separation technology

Description

The C-Thru® Separator is a unique, patented unit designed to remove solid and liquid contamination from coolants and cleaners throughout the metalworking and pretreatment industries.

Contaminants such as hydraulic oil, way lube, and rust preventatives continually enter the metalworking and cleaning fluids from the machine itself or parts being processed in the application.

Contamination of the fluid can cause:

- Decreased fluid life
- Increased hazardous fluid disposal
- Increased chemical concentrate purchases
- Increased bacteria activity leading to odor, rancidity and degradation of fluid
- Decreased tool life
- Increased machine downtime
- Increased smoke generation in machining process
- Increased use of filters due to media blinding
- Decreased cleaning performance leading to quality issues and rejects

The C-Thru® Separator is manufactured via injection mold producing a seam free, extremely durable tank. The tank has withstood being dropped from over 15 feet onto cement, hit with a 8 pound sledge hammer and driven over by a 10,000 pound truck. The chemical resistance of the resin is outstanding as it can withstand aggressive chemicals such as sodium hydroxide, sulfuric acid, mineral oil, kerosene, diesel fuel and isopropanol.

Benefits

- Extended fluid life
- 10 times more efficient than belt, disk, or rope skimmer
- Reduced waste disposal
- Increased tool life
- Simple and quick installation using magnetic base
- No consumables
- Compact
- No floor space utilized
- Easy to clean
- Patented, transparent design



Features

The C-Thru® Separator is compact and portable with installation made simple by attaching directly to the machine utilizing the magnetic base provided.

A float connected to a pump (electric or air) draws the contaminate oil from the surface of fluid. The tramp oil is separated and remains in the C-Thru® Separator where it can be drained off by opening the valve.

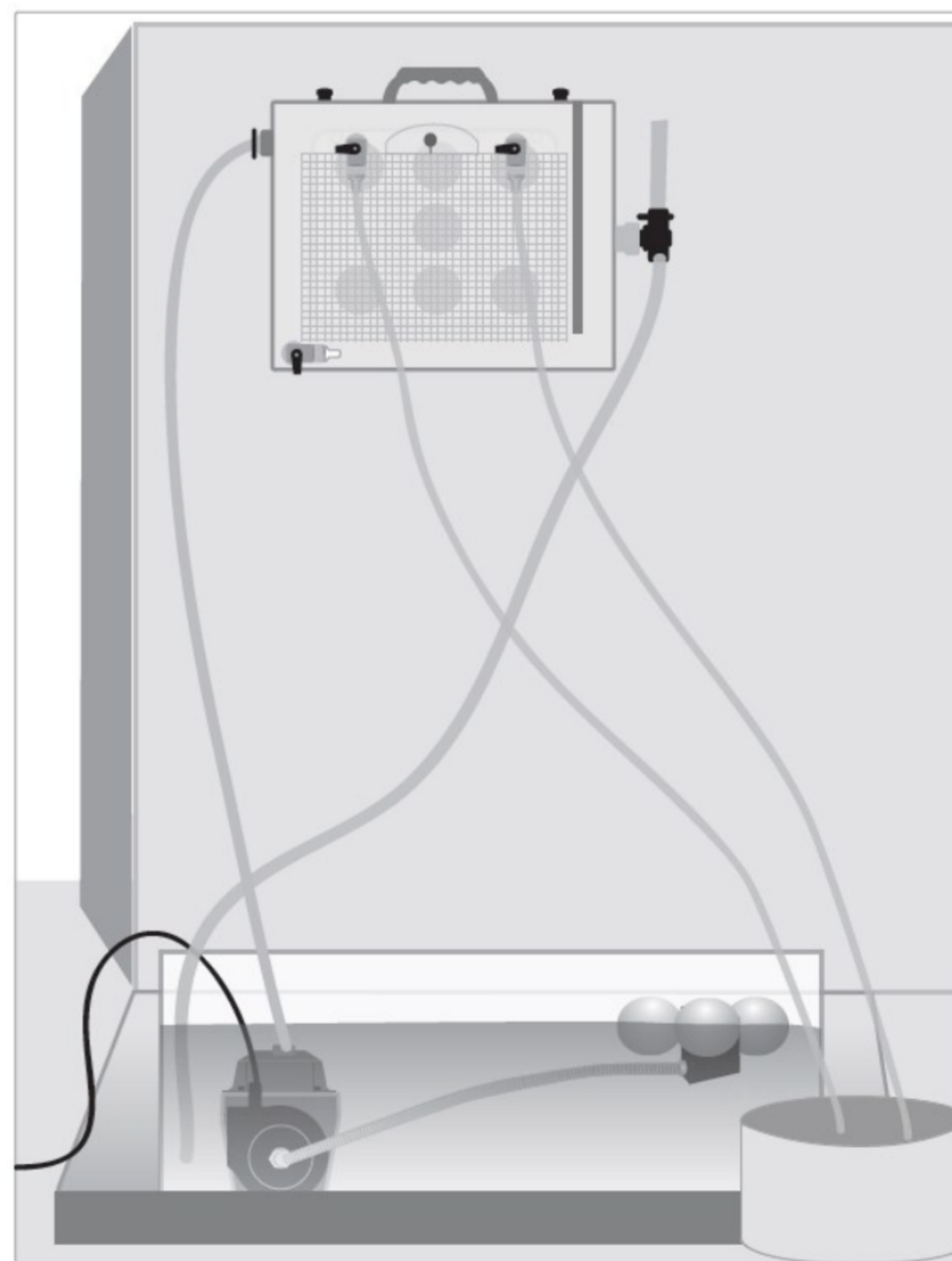

Technical Specifications

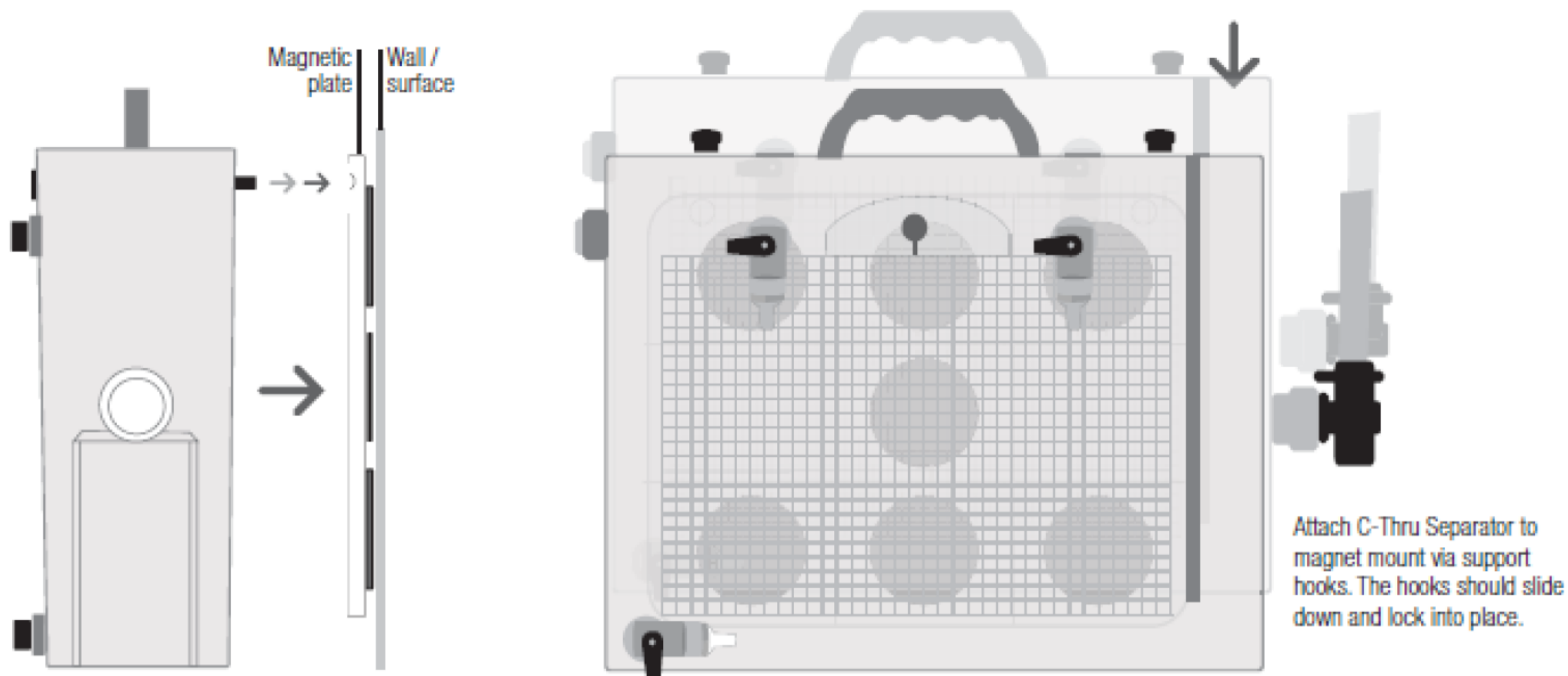

C-Thru® Separator Package Options

Submersible electric pump:

NJT 1500 C-Thru® Separator, 115V 60Hz pump, float, magnetic base and tubing

NJT 1550 C-Thru® Separator, 230V 50 Hz pump, float, magnetic base and tubing

NJT 1560 C-Thru® Separator, 230V 50/60 Hz pump, float, magnetic base and tubing

NJT 1575 C-Thru® Separator, 100V 50/60 Hz pump, float, magnetic base and tubing

Maximum Temperature: 100°F (38°C)

Applications: Metalworking fluids

Air pump:

NJT 1600 C-Thru® Separator, air double diaphragm pump, 10" filter, float, magnetic base and tubing

Maximum Temperature: 120°F (49°C)

Applications: Metalworking and cleaning fluids

Air pump high temperature:

NJT 1800 C-Thru® Separator, air double diaphragm pump, float, magnetic base and tubing

Maximum Temperature: 158°F (70°C)

Applications: Cleaning fluids



Specifications

Dimensions: Length = 18.8" (478mm)
Height = 14.3" (363mm)
Width = 4.7" (119mm)

Operating volume: 2.64 gallons (10 liters)

Required access to reservoir: 8.88" (225mm) for standard float



843.326.8939 Office
843.621.6091 Don
843.326.8949 Fax
don@kingind.net